



SHREEJI  
ATLANTIS

Call or Whatsapp  
Jitendra Patel : 8169681043

Luxurious  
2 & 3 BHK

BIG  
LIKE YOUR  
HEART





## **WELCOME TO THE SHREEJI ORLEM WORLD**

Shreeji Atlantis marks the dawn of Shreeji Orlem World - a symbol of real estate excellence and lifestyle extravagance in the western suburbs of Mumbai. Shreeji Orlem World is a medley of housing projects with future-ready homes. Here, you will find your dream home - a home that is spacious, luxurious and glorious.



SHREEJI  
ATLANTIS

# BIG. LIKE YOUR HEART.

Do you dream about a home that has ample space for the things that you like and people who you love? Come to Shreeji Atlantis! Here is your chance to experience total comfort and convenience in your own spacious 2 and 3 BHK apartment. Located right in the heart of Mumbai, Shreeji Atlantis shines like a diamond on the skyline of Orlem, Malad (W).



COMFY.  
LIKE  
YOUR HEART.

If you are looking for a home crafted for a metro lifestyle - Shreeji Atlantis is the ultimate destination! Our all apartments are embellished with the most comforting features such as - premium sanitary fixtures, granite kitchen platform, heavy aluminium sliding windows, designer entrance door, and anti-skid flooring - making them as comfy as possible.

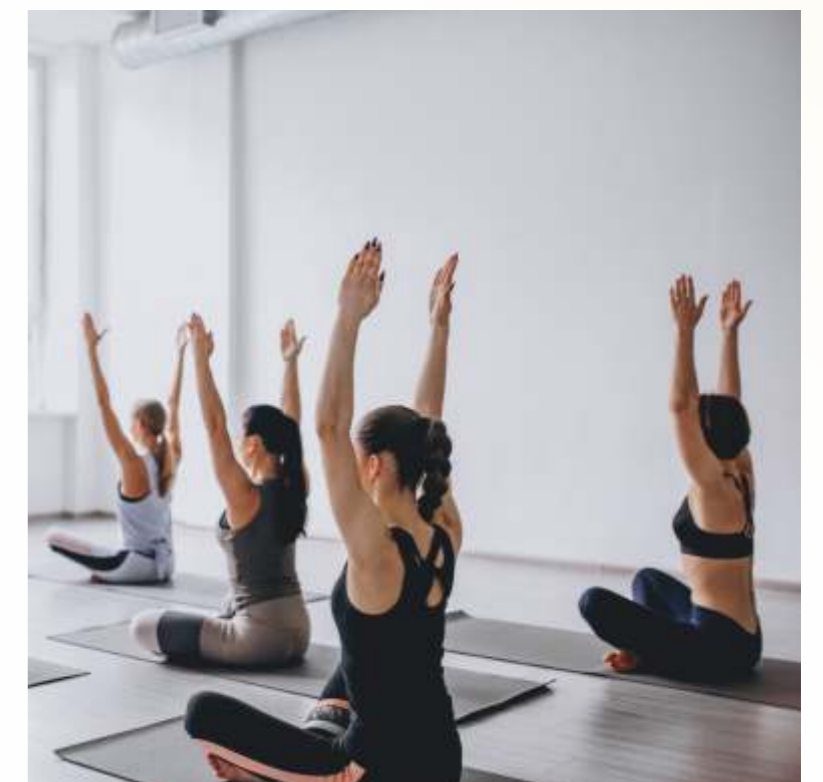

Whenever you long for some 'me' time amid hustle and bustle of Mumbai city – you'd find that place here at Shreeji Atlantis. Be it a family get-together or a meeting with professionals, be it some games with your children or a stimulating dive in the pool – Shreeji Atlantis has a dedicated space for everything. Living a healthy and happy life demands a lot more than just four walls. Get a home that comes with infinity swimming pool, gym, conference room, kids' play zone, and meditation corner and more to make every day delightful.

DELIGHTFUL.  
**LIKE**  
YOUR HEART.



A Home That Loves Having  
**FRIENDS OVER**



Artistic Impression

Shreeji Atlantis has a vibe that brings a new life into everything. Here you can relax, rejuvenate, recreate, and relive the life that you always wanted. It is the place where you will rediscover your destiny and redefine happiness.

**HAPPY.  
LIKE  
YOUR HEART.**



# Location Map

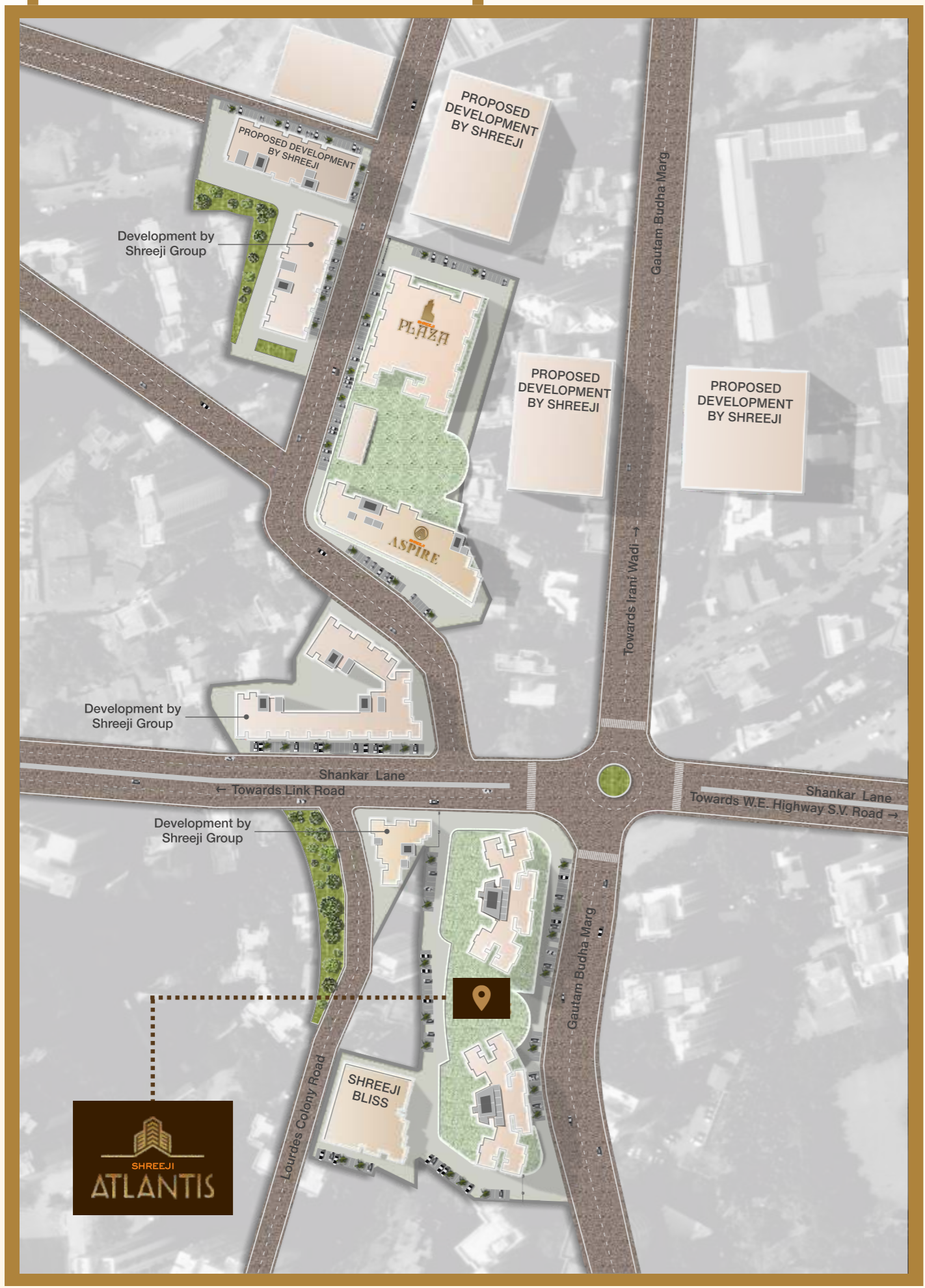
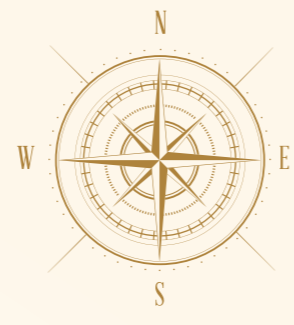

# Near By's



Hospitals



Malad Railway Station



Schools & Colleges



Markets



Shopping Malls



Restaurants



Financial Institute



Marve Beach



Sports Arenas



Link Road



Proposed Metro Station



Western Express Highway



Recreational Parks

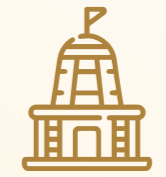

Places for Worship

- Near Malad Railway Station
- Two minutes drive from link road & S.V. Road
- Schools, Colleges, Gardens, Hospitals
- Worship Places in Neighborhood
- Malls & Markets within easy reach

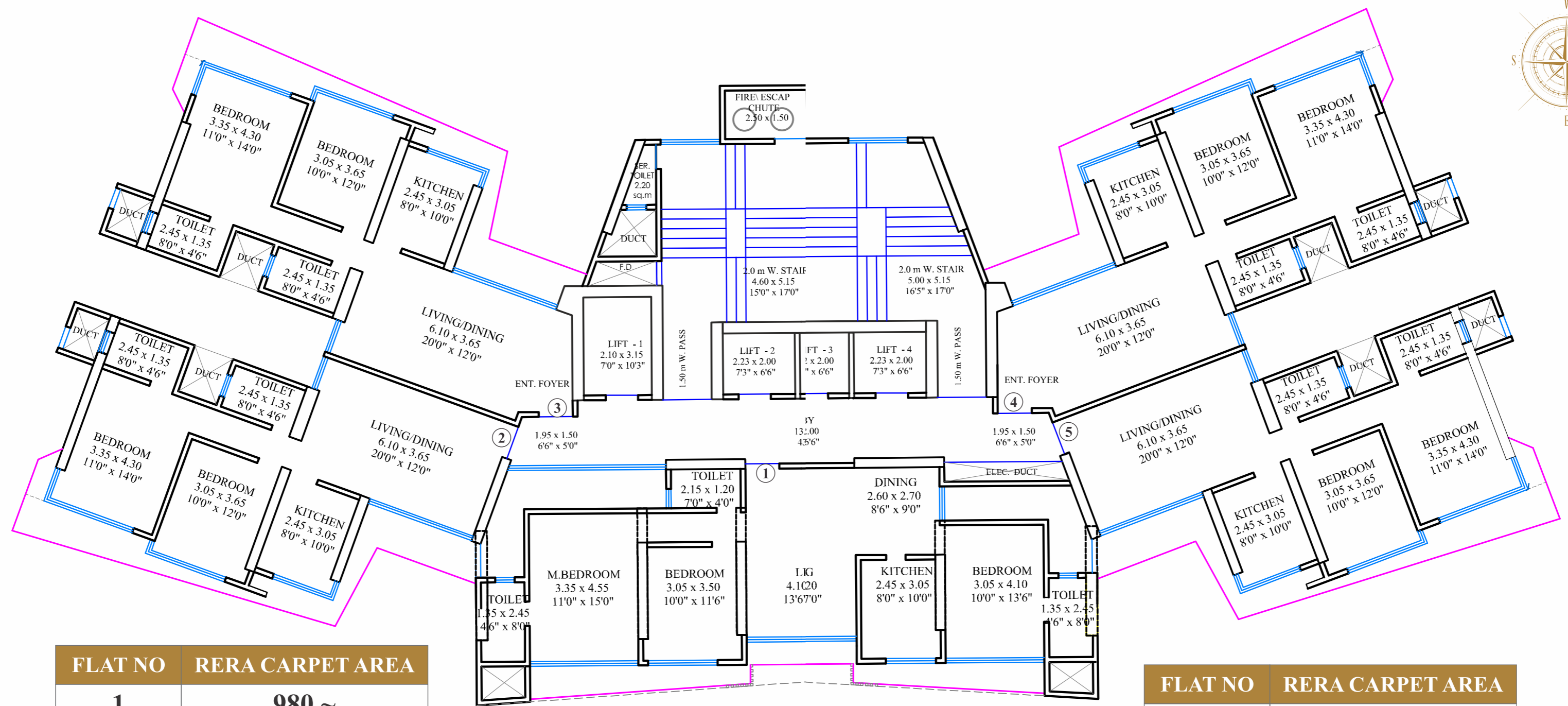

FLAT NO	RERA CARPET AREA
1	980 ~
2	734 ~
3	769 ~

FLAT NO	RERA CARPET AREA
4	770 ~
5	734 ~



**2 BHK FLOOR PLAN**  
Images for representation purpose only

## Floor Plan 2 BHK & 3 BHK



**3 BHK FLOOR PLAN**  
Images for representation purpose only

## Lifestyle Amenities



Infinity Swimming Pool



Health Club



Gymnasium



Half Basket Ball Court



Meditation Corner



Children's Play Area



Guest Rooms



Conference Room



Office Cabins

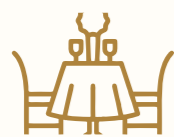

Banquet Hall



Open Café



Guest Parking

## Internal Amenities



### Apartment

- All plans will be with MCGM approval
- Heavy section, anodized aluminum sliding windows
- Elegant, designer finished entrance door and internal door with superior quality fittings
  - Ultra-modern elevation
  - Vitrified tiled flooring in entire flat
- Vaastu compatible plans
- Gypsum finished internal walls with plastic /flat paint



### Bathroom

- Premium sanitary fixtures & CP fittings
- Anti-skid flooring
- Ceramic tiled wall
- Instant water heaters, Racold or equivalent
- Naturally ventilated bathroom with an exhaust fan



### Kitchen

- Granite platform
- Provision for water purifier
- Ceramic wall tiled above the platforms
- Exhaust fan
- Scratch resistant stainless steel sink



### Security

- Advanced fire-fighting systems
- Earthquake resistant structure
- Biometric security system
- 24 hours CCTV surveillance



**SHREEJI**  
**ATLANTIS**  
Excellence over ordinary

**Developers**  
Shreeji Construction

**Architects**  
V. S. VAIDYA & ASSOCIATES  
Mr. Rajesh Khandeparkar

**Design Architects**  
P. R. Consultants  
Piyush Solanki

**RCC Consultant**  
Shanghvi & Associates Consultant Pvt. Ltd.  
(SACPL)

**Advocates & Solicitors**  
Juris Corp.



1<sup>st</sup> Floor, Shreeji Atlantis, Gautam Buddh marg, Off Marve road, Malad (W), Mumbai - 400 064.  
Tel.: 022-2867 3940 | Email: sales@shreejigroup.net

Call Or Whatsapp : Jitendra Patel :

**+91- 81696 810 43**



**Shreeji Atlantis (Wing A)**  
Maha RERA Registration No.  
**P51800004400**  
<https://maharera.mahaonline.gov.in>

**Disclaimer:** The Information contained in this brochure is indicative of the kind of development that is proposed and it is subjective to the approval of the authorities.  
The Developers reserve their right to make changes or alteration at their sole discretion. All the plans and pictures used are rendered according to artist's perception.